



Life • Health • Happiness

MIRACLE MAX™ PLUS⁺ WATER IONIZER

Drink Pure Mineral Ionized
Alkaline Water Everyday

Drinking fresh Alkaline Ionized Water, with
smallest water molecules will give your body
more anti-oxidant power and deep hydration.



Acid Water under 3.0 pH can be used as a Organic Water
Based Cleaner to kill most germs & bacteria.



Contents

Product Description	1
Installation	5
Product Usage	7
Instructions	10
How to change the filter	13
Warning	14
Troubleshooting	15
Specifications	17
Maintenance Records	18

Product Description

Front View

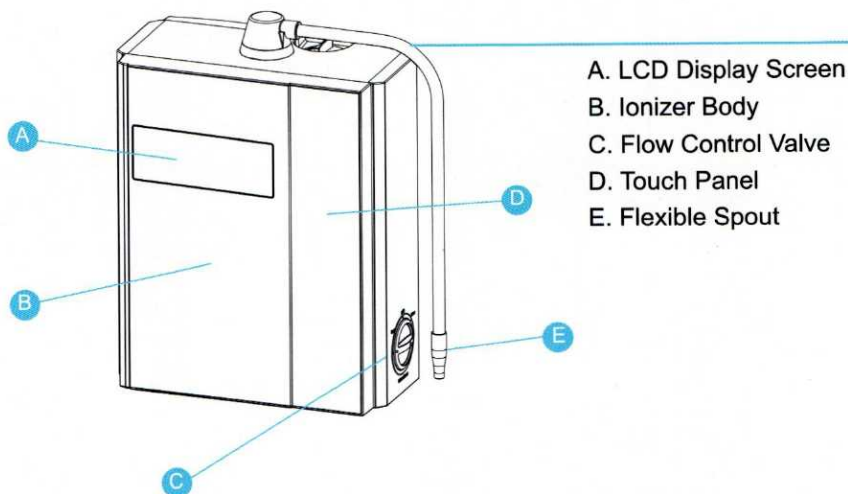

Back View

- F. Mineral Insert Port
G. Mounting holes
H. PJ-6000 Filter Panel
I. Power Cord

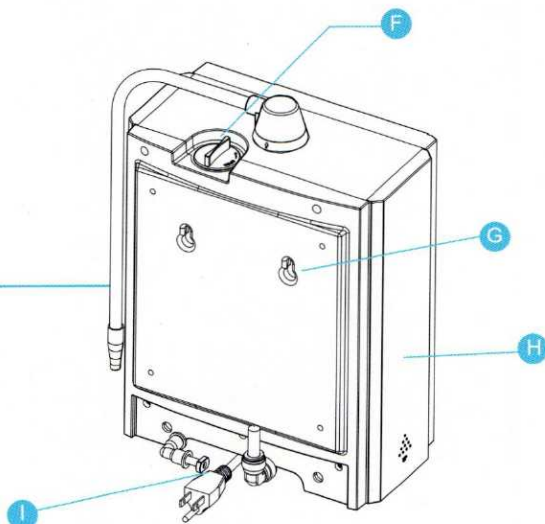

Bottom View

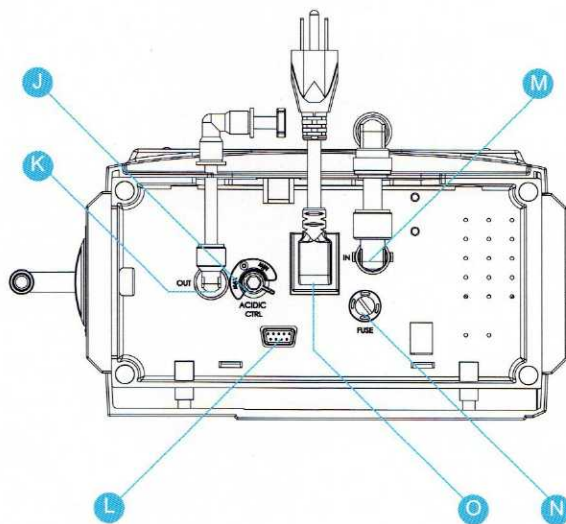

J. Drain flow regulator valve

K. Drain water outlet

L. Software Update Connection

M. Source Water Inlet

N. Fuse

O. AC Socket

Product Description

Installation Accessory Kit

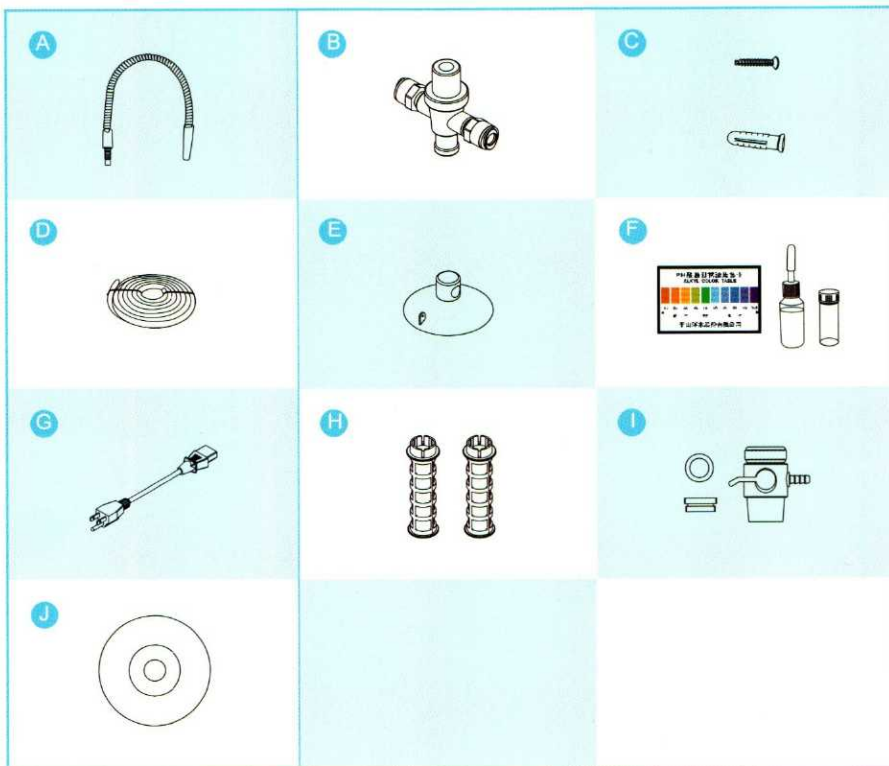

A. Flexible spout

B. Pressure reducer 1/4"

C. Mounting Kit

D. 150 cm of 1/4" tube

E. Drain Suction Cup

F. pH reagent drops kit (pH Reagent Drops, pH Testing Bottle, Color Chart).

G. Power cord

H. Mineral Insert Basket - One installed into device

I. Faucet Diverter 1/4"

J. Chanson Informational CD

Basic Installation Diagram

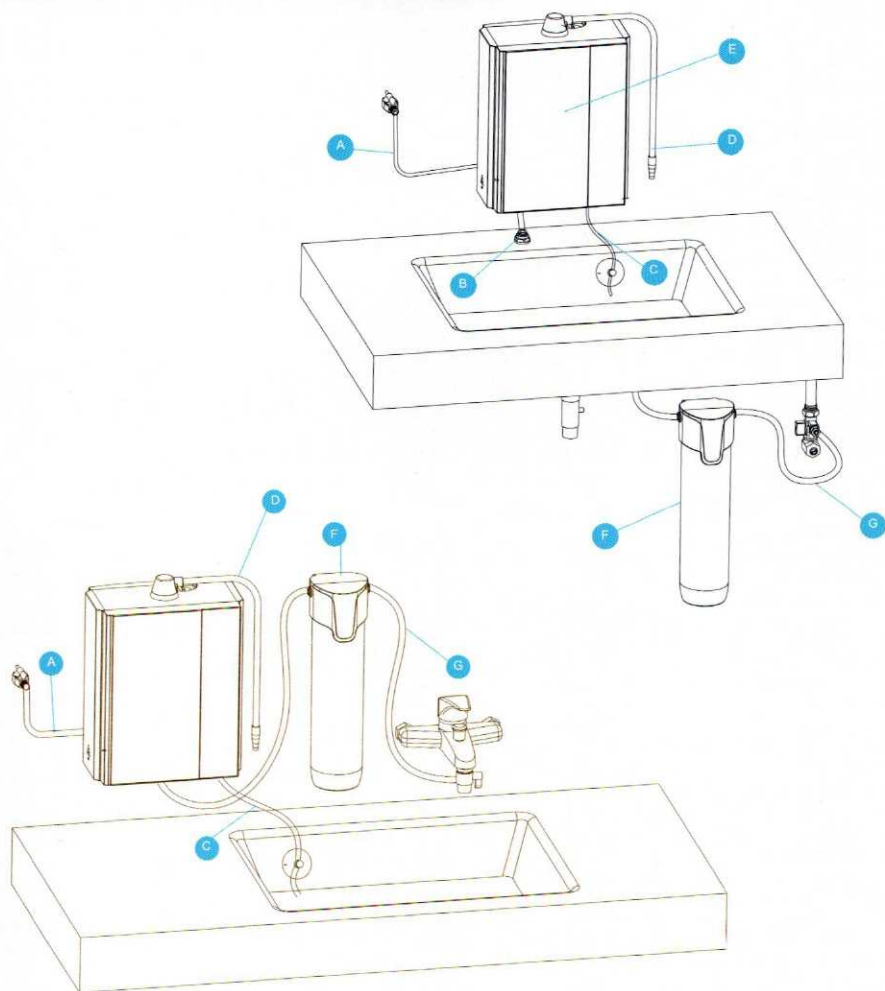

- A. Power Cord
- B. Water Input Connection from Pre-Filter
- C. Water drain output tube
- D. Flexible Spout
- E. Ionizer Body of Miracle Max Plus.
- F. Pre Filtration (Not Included)
- G. Cold water line connection from Main

Installation

Faucet Diverter Installation Method

A Installation of faucet diverter.

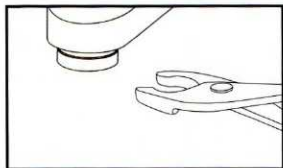

Step
1

Remove aerator (tip of the faucet)

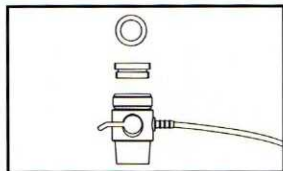

Step
2

Make sure you have the faucet diverter with the rubber gasket and aerator extensor if needed for female threads on faucet.

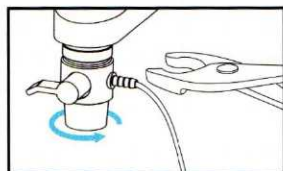

Step
3

Screw in the faucet diverter

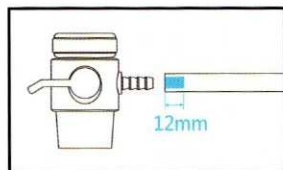

Step
4

Slide 1/4" tube over the barbed water connection on the faucet diverter. Must go in at least 12 mm and put hose clamp.

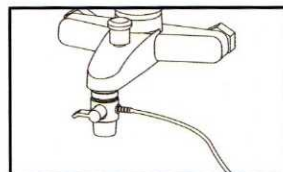

Step
5

Use pliers to give an extra 1/4 to 1/2 of a turn and make sure it is tightened and ready to use.

B Water inlet tube connection.

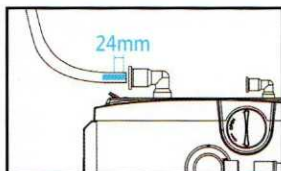

Take the end of the tube connected to the faucet diverter and insert into water inlet quick connect. Push in as far as you can, it should go in about 24 mm.

C Water outlet tube connection.

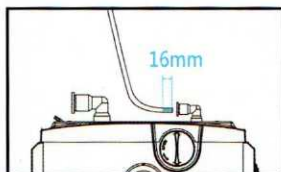

Step
1

Insert the end of the hose into the water outlet quick connect. Push in as far as you can, it should go in about 24mm.



Step
2

As shown in the picture the output end of the tube will go in the sink held by the suction cup.

D Flexible Spout Installation.

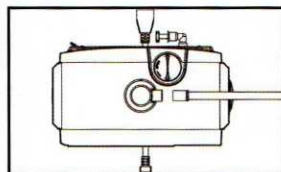

Step
1

As shown in the picture the flexible spout is screwed into the rotating neck of the ionizer.

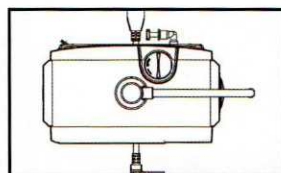

Step
2



Turn clockwise until O-Ring on flexible spout is in. Do not over tighten.

Product Usage

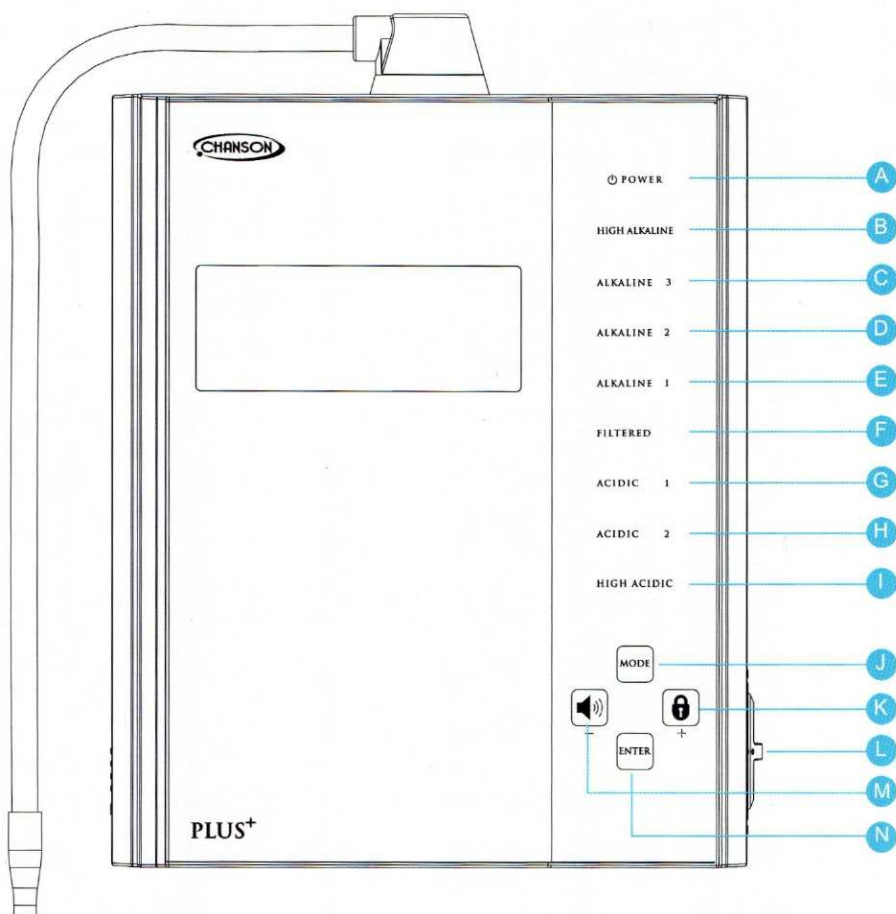
Touch Panel Description



Schematic View of Buttons on Front Side

A Power Button	Press power button to turn ionizer on and off.
B High Alkaline	High Alkaline pH perfect for soaking fruits and vegetables
C Alkaline 3	Great pH for drinking and replenishing the body with mineral filled water
D Alkaline 2	Perfect level for cooking and baking foods
E Alkaline 1	For people new to drinking ionized water
F Filtered	Filtered water for taking medication or making baby formula.
G Acid 1	For washing face and moisturizing skin
H Acid 2	Using as an Organic cleaner
I High Acidic	Cleaning and Disaffecting germs and bacterias
J Menu	(1) Used to switch between pH and ORP on the screen as the water is being ionized. (2) Used to access the back menu settings.
K Lock Button	 Lock the ionizing level that is used normally
L Side Flow Control Valve	Control the flow of water to get higher ionized values
M Volume Button	 Adjust the volume of the ionizer
N Enter	Confirm button when in settings mode

Product Usage

LCD Screen Features

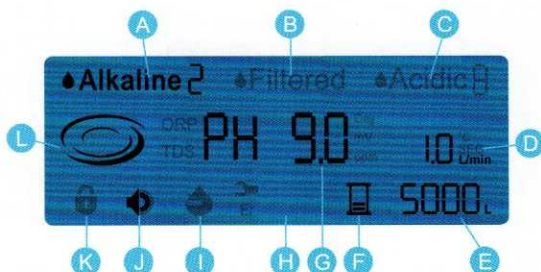

Alkaline Water Segment View



Acidic Water Segment View



Water Purification Segment View



ORP View

- A Alkaline Water Level Indicator
- B Filter Water Indicator
- C Acid Water Level Indicator
- D Flow Rate
- E Filter Life Counter: Shows remaining liters of water
- F Filter Life Indicator
- G pH Indicator :

This value is the suggested value at this level. Due to different water conditions the pH levels may be different.

- H Error code indicator.
- I Low water flow indicator :

When water flow is too low or no water is detected this warning will appear.

- J Volume Icon.
- K Lock icon : Lock a Specific Ionizing level on device
- L Ionization Indicator: Symbol will appear when ionization in process
- M ORP Indicator:

This indicator is a guideline of what the ORP should be at this level.

This number will correspond to the amount of power placed on the plates.

Instructions

Plug the power cord into the power outlet. You will notice that the LCD screen lights up and changes in 7 different colors while making a prompt sound. If the ionizer is not on or no button is pressed the ionizer will remain on stand-by mode for about 1 minute and it will go on sleep mode (time out). You can press any button to wake the ionizer up and be on stand-by mode again.

It is also important to keep in mind that the ionizer will automatically turn itself off after running for 15 minutes on the same water level.

How to use your ionizer:

- A** Select level: Press the desired water level and press the "Power" button to turn ionizer on. Press the "Power" button again to turn ionizer off.
- B** You can change the selected water level at any point as the ionizer is producing the electrolyzed water, except the High Acidic level.
- C** High Acidic level can only be selected when the ionizer is off. While the ionizer is producing this water level you will not be able to change to any other setting. To do so you need to turn the ionizer off. Remember that when you select any other water level after using the High Acidic level the ionizer will go into the self-cleaning cycle as a safety feature.
- D** Drain Control Valve: This valve will allow you to somewhat modify the amount of water that goes out from the top flexible spout and the drain tube. As you lay the ionizer on the back you will see this valve next to the drain water outlet on the right side. When the valve points to "Max" the water ratio will be 1:1. When the valve points to "Min" the amount of water coming from the drain will be smaller compared to the amount of water coming from the top flexible spout.



Drainage knob points to MIN



Drainage knob points to MAX

Instructions

- E** Mineral Basket: This will allow you to add minerals to improve the quality of the water and facilitate in some cases the ionization process.

- 1 Remove the cap of the mineral basket port turning it counter clockwise.
- 2 Fill basket with mineral (calcium, magnesium, Himalayan rock salt).
- 3 Lock basket on the cap and put back on mineral port. Turn clockwise to lock.
- 4 Select the level of desired water level and turn ionizer on.

Note:



Minerals like calcium and magnesium are only recommended for alkaline water levels and the Himalayan rock salt is recommended to be used only with the High Acidic level. If you have any minerals left remove basket and store. Do not leave mineral basket with minerals inside.

Instructions

Setup

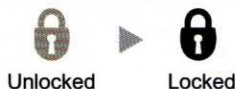
Lock Option



Select the desired water level that you want to lock and press and hold the "  " button for 3 seconds and you'll hear a voice prompt indicating that the pH has been locked and you'll see the Lock icon "  " on the screen. To unlock press and hold the "  " button again for 3 seconds and you'll hear a voice prompt indicating pH unlocked.

TDS Value Adjustment



Press and hold the "  " button for 5 seconds to access the back menu setting. This will be the first parameter that the ionizer will allow you to change. Press the "+" or "-" button to increase or decrease the value in the screen. Press the "Enter" button to save. Press and hold the "Menu" button for 5 seconds to exit.

Power Adjustment



Press and hold the "  " button for 5 seconds to access the back menu setting. Press the desired water level to be modified and then press the "+" or "-" to change the parameter. Press the "Enter" button to save selection. Repeat to all the water levels that you want to modify. Press and hold the "Menu" button for 5 seconds to exit.

Instructions

Setup

Language



Press and hold the "MODE" button for 5 seconds to access the back menu setting. Press enter until you see a language option. Press "+" or "-" to change the language and press "ENTER" to save selection. Press and hold the "Menu" button for 5 seconds to exit.

Self Cleaning Cycle Setup



Press and hold the "MODE" button for 5 seconds to access the back menu setting. Press enter until you see "Clean" on the screen. Press "+" or "-" to select the frequency of the cycle (options from every 10 to 60 liters) and then press enter to save selection. Press and hold the "MODE" button for 5 seconds to exit.

Reset Filter Count

Press and hold the "MODE" button for 5 seconds to access the back menu setting in the "self cleaning cycle" page. Press the "MODE" button and the "i" button at the same time. You'll notice that the filter count will go back to 9000 and the grind will be full again. Press and hold the "MODE" button for 5 seconds to exit.

Default Reset

This will bring all the values to its original factory settings. Press and hold the "MODE" button for 5 seconds to access the back menu setting in the "self cleaning cycle" page. Press and hold the "Speaker" and "i" buttons at the same time for 5 seconds after it prompts the change press the "ENTER". Press and hold the "MODE" button for 5 seconds to exit.

Volume Adjustment



Press the "  " button to change the volume of the sounds of the ionizer. You have 4 volume options: Low, Middle, High and Mute. From factory default your ionizer will be set on Middle, and every time you press the volume button it will scroll through the different volume settings and making a sound simultaneously as a sample of the volume.

How to change the filter

There are 2 different indicators that will tell you when it's time to change the filter. The grid indicator and the 9000 liter indicator and the time to change it will be whichever reaches 0 first.

Full grid (5 grids) will indicate a new or just replaced filter and will represent a full year (365 days). Each grid will represent 73 days and they will go down as these days pass. Once there are no grids and the icon is flashing it is time to replace the filter.



The 9000 will indicate the average usage of liters during a year as the water flows through the ionizer. Once the number reaches 0000 and the icon starts flashing it is time to replace the filter.

Keep in mind that there is no way that the ionizer will be able to quantify the amount of contaminants that have been removed. It is also important to remember that if your only filtration system is this small filter in your ionizer you should replace it every 6 months and not wait for any of the 2 indicators to get to 0.

1
Looking at the ionizer from the front remove the right panel by sliding it upwards.

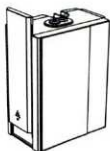

2
Tilt the filter housing to the side.

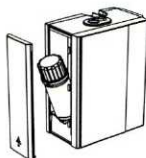

3
Hold tight the filter housing and turn the filter cap counter clockwise to open it.

4
Remove the filter cap with the filter (filter will be attached to the cap).



5
Hold cap with filter and turn the filter counter clockwise to remove.

6
Make sure to save flat rubber disk and migrate to new filter (rubber disk might be on top of the old filter or stuck on the filter cap).

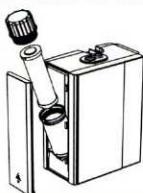

7
Place flat rubber disk on top of new filter and insert filter onto filter cap. Turn clockwise to lock filter on cap.

8
Insert filter with filter cap into the filter housing. Hold filter housing and screw cap back by turning it clockwise.



9
Push filter housing in.

10
Insert filter with filter cap into the filter housing. Hold filter housing and screw cap back by turning it clockwise.

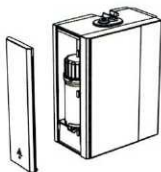

11
Do filter count reset (Please refer to Filter Count Reset on set up instructions).

Warning

1. It is important to make sure to close all water supplies and to unplug the ionizer from power outlet if you will not be using it for an extended period of time.
2. Do not try to repair or modify any parts of the ionizer yourself. Opening the ionizer or making any modifications will void the warranty.
3. Do not plug and unplug the ionizer to an electrical outlet repeatedly. This will cause electrical damage to the ionizer and void the warranty.
4. Do not use a damaged power cord. Contact your dealer or service center for replacement.
5. Remove any dust and dry any water from the power cord as this will cause electrical problems and could be the cause of fire.
6. Do not use excess of water or any abrasive cleaner (like benzene or gasoline) to clean any part of the ionizer. Make sure the ionizer is unplugged from the power outlet when cleaning it. This will help prevent damages to ionizer's body or electronics.
7. Do not install ionizer in areas of extreme cold or heat..
8. If you notice any leaks from the machine, please immediately close the water supply and unplug the ionizer from the power outlet. Contact technical support for assistance.
9. If the ionizer starts making atypical noises or starts acting up when using it, unplug ionizer from power outlet and contact technical support for assistance.
10. Do not place any objects that can create a fire close to the ionizer as this could cause damage to the machine.

When moving the ionizer do not pull the power plug, it may come off from the power

11. outlet or from the power cord connection underneath the ionizer and cause electrical damage.
12. Do not plug ionizer if electrical socket on ionizer or power outlet are loose. This could cause electrical damage and create a fire.
13. Do not touch power cord, electrical socket or power outlet with wet hands to avoid electrical shock or fire.
14. Do not bend or pinch power cord or place under heavy objects that might damage the power cord. This could result on electrical shock or cause a fire.
15. Do not use multi-socket power outlet to plug in ionizer especially if it is being used to power up other appliances in order to avoid electrical issues.
16. Do not attempt to repair power cord. Disconnect from power outlet and contact technical support for a replacement.
17. Make sure that the power outlet socket has a ground connection.

Troubleshooting

Problem	Verify	Solution
Internal leak from ionizer	Where is the leak coming from	Contact technical support for troubleshooting and instructions.
Leak from inlet or outlet fitting	Check fitting and tube to identify where exactly the leak is coming from	Remove the tube and check that the shape is round and the cut is straight and not at an angle and reconnect to fitting making sure it goes as far in as possible.
Not altering the water	pH reagent drops might be expired or spoiled.	Contact your dealer or customer service to order more pH testing drops.
	Check the water flow it might be too high.	Reduce flow as needed.
	Possible calcium buildup	On hard water areas it is recommended that in addition to the self cleaning cycle of the ionizer to do frequent citric acid flushes to reduce this buildup according to the hardness of the water source.
Bleach smell from acid water	Making acid water might produce hypochlorous acid when making acid water which is what gives the bleachy smell to the water.	This is harmless to the skin.
White flakes in the alkaline ionized water	The ionization process concentrates the calcium in the water.	This is harmless. You can use the water.
	Calcium buildup on electroplates	On hard water areas it is recommended that in addition to the self cleaning cycle of the ionizer to do frequent citric acid flushes to reduce this buildup according to the hardness of the water source.

Troubleshooting

Problem	Verify	Solution
Restriction of water flow.	Check the side flow control valve, water diverter valve and main shut off valve.	If any of these is closed or partially closed water will be restricted.
	Have the filters been change?	If they haven't flow restriction could be an indication that you need to replace the filters. Also something in the water might be clogging up filters and restricting the water flow
	White flakes in water due to calcium buildup	On hard water areas it is recommended that in addition to the self cleaning cycle of the ionizer to do frequent citric acid flushes to reduce this buildup according to the hardness of the hardness of the water source.
Water dripping from drain outlet after use.	Verify if it stops after a few seconds after turning ionizer off.	This is normal as there will still be water inside the ionizer even after being turned off especially from the drain. If after a long time after using it water is still dripping contact technical support for further assistance.
Bad odor coming out from ionizer.	Verify if filters have been replaced	Contact your dealer to purchase new filters.
Error code comes up on screen	Verify number of error code.	Contact technical support for further assistance.
	Verify that it is connected to the power plug.	If it isn't connected please reconnect to power outlet.
	Check if the power outlet has a GFI switch.	If so, press the reset button.
Ionizer is not turning on at all.	Check the ionizer's fuse.	Replace if it's burned.
Ionizer stops automatically and turns off.	Verify if the ionizer has been running for a long time.	If so, remember the ionizer will shut itself off after 15 minutes of use.
	Verify there was no overheating error on the screen.	If this is the case, wait 60 minutes before using the ionizer again to allow enough time to for the ionizer to cool down.

Specifications

Model	Miracle Max Plus
Rated Voltage/Frequency	100~240V, 50~60Hz
Power	175W
Ionizer Dimensions	Width: 9.84 / Height: 13.31 / Depth: 6.69 (inches) 250 / 338.2 / 170 (mm)
Maximum water pressure	8~70 psi
Water Temperature	41 - 104° F / 5 - 40° C

Maintenance Records

[illegible]

- The replacement time depends on water quality condition and usage yield.
- Enjoy your excellent life with regular filter replacement.



Benefits of Using Chanson Ionized Alkaline Water

- Alkaline ionized water helps to neutralize body acidity. Many health professionals believe this is a key to disease prevention and improved health.
- Alkaline Water functions as a powerful antioxidant while seeking out free radicals in the body. This is a great way to help guard against illnesses and chronic diseases.
- Micro-clustering of water molecules into smaller groups allows Ionized water to have superior absorption and hydration. To accelerate the body's metabolism so you can feel young, refreshed, and healthy.
- Good minerals from Alkaline Ionized Water are more bio-available to the body's needs and satisfy your daily mineral requirements.
- Alkaline Ionized Water makes food taste better and is great for all types of food preparation and cooking.
- Acid water has over 500 uses! It can be used as an organic moisturizer, cleaner, stain remover and has been proven to be able to kill 99.9% of bacteria. Replacing up to 50% of harsh household chemical cleaners.
- Chanson Ionizer is not just a water machine but a lifestyle machine where the water produced can be used to benefit all aspects of daily life.

ISO 9001:2008

